



*Shepherd*  
OF THE PRAIRIE  
LUTHERAN CHURCH  
Caring For All God's Children

## Congregational Newsletter April 2016

### Statement of Purpose

*"We care for God's children of all ages by growing disciples who make disciples."*

**It is with much excitement that the Building Team has revealed the Conceptual Master Plan from our architects at Groth Design Group, and construction firm, Shales McNutt.**

The Reveal held on Wednesday, March 9th was a huge success, where Paul Barribeau, and Bill Wilson showcased the latest church designs to our congregation, including elevations! We would like to thank everyone that attended the Reveal, and to those who stayed afterwards to ask additional detailed questions.

**Those that were not able to attend the Reveal, or perhaps for those that would like a clearer and more detailed view of the designs, please go to the SOTP website to view the video along with the power point slides that enhance the presentation.**

Your Building Team will meet multiple times in the coming weeks to discuss the results of the congregational input, along with implementing the architectural guidance given towards determining the next phase of our Mission Center Journey.

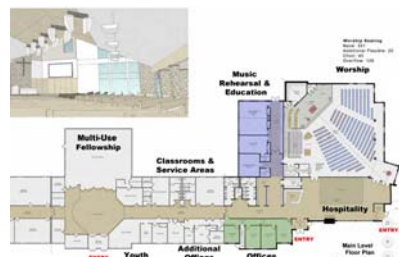
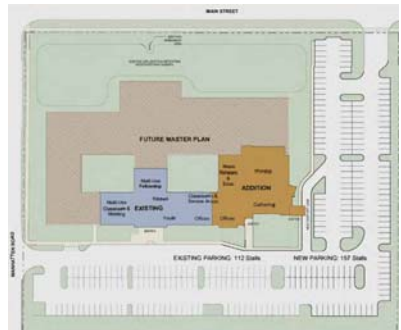

10805 Main St, Huntley, IL 60142 • Phone: 847-669-9448 • [www.sotp.org](http://www.sotp.org)  
Office Hours: 9:00 a.m.-noon, Mon-Fri

## *A Note From Pastor Mark*

Brothers and Sisters in Christ,

Whatever your level of belief, know that Jesus is in charge of both life and death. He walks with us each day.

He allows the real stuff of life to challenge us and teach us. He rescues us from being destroyed by the hardness of life. He gives us peace of mind when we are confused. He promises to be there for us at death's door and beyond.

Looking once again at the Easter from John we hear the words of our Lord once again, "Peace be with you" spoken to his followers on the next evening following his resurrection. His disciples were probably feeling anything but peace as the political and religious powers went about destroying remnants of Jesus' ministry. They clung together behind locked doors in fear. But Jesus found them, walking right through the locked door.

A week later he comes to them again and repeats "Peace be with you."

I remember times when Jesus' peace was with me in difficult situations and I couldn't understand how it could be?

There were many other times that I felt like Peter at the tomb, confused and bewildered about life's happenings, and didn't open my heart and mind to Jesus' peace.

Jesus tells us that he knows his own. He not only knows our name and thoughts but he knows how many hairs are on our head. He knows how we were formed in our mother's womb.

It is a relief to know that when Jesus called Mary by name at the tomb, her confusion and despondency left her and she recognized her Maker. These are some of the most tender words in all of Scripture.

We have hope that when Jesus calls each of our names, our eyes will be opened, our hearts will burn with love and understanding, and peace will come upon us as we see the "Truth" face to face.

Meanwhile, until death's call, we have the privilege of walking with our Lord by reading God's life giving Word and in prayer with him. Even though life will still be confusing and difficult at times, we can continue to build our relationship with him.

*(Continued on page 3)*

- What scriptures give you hope?
- What life experiences have been difficult for you? What helped you get through them?
- Have you been a source of hope for another in trying times?

Ponder these questions and be faithful in your life as a disciple. I'll see you in worship.

*Pastor Mark*

## *Pastor Bill's Adult Education News*

What do John and Abigail Adams, James and Dolly Madison, and Ronald and Nancy Reagan have in common? Aside from the obvious, all three couples wrote love letters to each other. Some have been preserved. Others, like the Madison's, were destroyed. In fact, Dolly Madison intentionally burned all theirs. More's the pity. But love letters these three couples did send, a lost art today.



The apostle Paul also wrote a love letter--to the church at Philippi. Although short, only four chapters, it expresses his great affection for those early Christians who made up the first church in Europe. Paul, of course, wrote other letters too, many of which have been preserved in the New Testament. But those are different in tone. Romans and Galatians are theological treatises. His letters to the Corinthians and Thessalonians address current problems and challenges in those congregations. But his letter to the Philippians, even though there were issues to be resolved, is full of love. "I thank God every time I remember you, constantly praying with joy in every one of my prayers for you," he begins.

So during the Easter season, we'll focus on this letter, beginning April 3. We'll meet each Sunday morning at 10:20 and then twice on Wednesdays -- at 11:00 in the morning and at 7:00 in the evening. We'd be delighted if you'd join us!

*Pastor Bill*

## Ministry Musings

Forward In Faith...that is the theme for our capital campaign and building program. And that is truly what this new building will do; help us move forward in faith to serve God and our neighbor.

I have been excited and amazed as I have watched us move from the tiny glint of an idea to full-blown plans and how generous and servant-like this congregation has been. Each team or group within SOTP has their own ideas about what we need and what is important for the life and service of this place. But I have also seen how these same groups and teams are willing to compromise and be patient in having their dream and plans fulfilled. We've seen how we need to concentrate on what will best help us to serve God and our neighbor rather than our own priorities and agendas. We only have so much money and that has to be put to the best possible use.

So while we each may not be able to see our own ideas come to pass and our own desires fulfilled right now, we can trust that God is guiding us and our building team to follow the right path, at the right time to enable us to, "Care for God's Children of All Ages By Growing Disciples Who Make Disciples."

May God bless us on this journey with peace and confidence in his will for SOTP.

*Donna Kelly* —Lay Ministry/New Member Coordinator

### MINISTRY OF THE MONTH ~ WORSHIP MINISTRY TEAM

"Welcome to Shepherd of the Prairie". "Happy to see you – thanks for worshipping with us". "Good morning – welcome." These are familiar greetings you may receive as you approach the entrance to the church.



"Would you like a bulletin?" "Do you need assistance finding a seat in the Sanctuary?" "Good morning-great to see you again." Greetings from the ushers positioned at the doors to the Sanctuary.

The greeters and the ushers faithfully invite members and visitors to worship services every weekend and on special occasions. You are greeted with a smile and many times a special hug of friendship. They are there to assist and direct. We are so blessed with their dedicated service.

As you prepare to worship, do you glance around the Sanctuary and reflect

*(Continued on page 5)*

## MINISTRY OF THE MONTH ~ WORSHIP (Continued)

*(Continued from page 4)*

on the beauty of the banners, flowers, and video presentation outlining the “happenings” at Shepherd of the Prairie? You may notice the Lord’s Supper placed on the Altar. You silently reflect on our God of forgiveness and prepare your heart to receive His Word.

At SOTP, we praise God in many ways – Cherub, Blessings & Treasures Choirs; Youth Band; Shepherd’s Voices (Adult Choir); Rejoice Band; Joy Ringers; Jubilate Ringers, Jubellation Ringers, Prairie Ringers, plus the hymns chosen for the day and the many special groups/soloist during the seasons. Maybe there is a drama to reflect God’s word in action. Each week Pastor works with members of the Worship Team to prepare for the weekly worship service – liturgy, hymns, audio/video presentations. Wow – quite a large group involved with weekly services! At times, there can be up to 100 people busily preparing to share the Word of God to you. The service prepared allows you to reflect and receive God’s Word in many forms.

But that is not all. Yes many more individuals are involved with scheduling members as Communion Stewards, Readers, Communion Bread Bakers, and preparers of the Lord’s Supper for each service.

This is an amazing group ~ but wait one more to mention. The nursery is always open and available for parents. The staff is friendly and focused on each child.

I would like to recognize the leaders for each area of worship: Altar Guild/Communion Bread Bakers – Judie Symbal, Readers/Communion Stewards/Assistant Ministers – Brigitte Pelka, Home Communion Service – Sharon Newbauer, Seasonal decorators – Barb Pagano & Carolyn Cuttle, Faith Chest – Chris Trodahl, Baptismal Blanket – Alice Hallett, Greeters – Dolly Cardascio, Ushers– Drew Szekely, Weekly flowers – Brandi Lorenzo, Music – Jane McMullan, Audio/Video – Greg Dowell, Drama – Chris Solem. Nursery – Jen Powe. *Thank them for their service the next time you see them.*

**I wish I had room to name all the individuals** under each leader that actively help to make each Worship service special. From the bottom of our hearts, we thank you for making our jobs easier and enjoyable.

Also a special thanks to Pastor Mark and Pastor Bill. You tirelessly listen to questions, new ideas and guide us with open and trusting hearts. We recognize Jane McMullan as our “worship service” leader. You inspire us to reach deeper and to honor and love God in every area of worship. Thank you very much!!!!

Please join any of the groups listed above. A vibrant growing church is one of active participating members. ~ Pat Fiorese

## POSTCARDS FOR CHILDREN

SOTP's GEMS group (*GIRLS EVERYWHERE MEETING their SAVIOR*) along with the SOTP Mission Team are involved with SEND KIDS THE WORLD.

Send Kids the World is an organization where terminally ill children receive post cards from people all around the world. The families are hoping that the child will receive much pleasure from receiving mail, as they struggle with life from day to day.



The GEMS will be in the east wing with post cards that they have collected from all over the United States, as well as other countries!!!

**Please support the GEMS, as well as SOTP Mission Team by walking down by the restrooms and filling out a postcard for a terminally ill child.** They will be there before, in between, and after services:

- April 9 & 10.
- April 16 & 17
- April 23 & 24

You can't miss the girls ~ they will be in their HOT PINK T-Shirts that they made.

*(Postcards are still being accepted.)*

## LITTLE LAMBS

**We are now accepting registrations for the 2016-2017 school year.**

Our program is Bible-story-based and includes developmentally appropriate structured time (*craft, music, calendar, learning activities, etc.*), as well as free play. We have programs for children ages 2 - 4 by September 1, 2016.

Children do not need to be potty-trained. Our class sizes are small (*not*

*more than 10 children in the 1 day classes on Wednesdays or 12 in the 2 day classes on Tuesday and Thursday*). Children are welcome to attend classes 1, 2 or 3 days.

Classes meet from 9:00 a.m. until noon.

Our classes are open to members and non-members of SOTP.

For more information, availability, and tuition/registration fees, see our "Registration" page on our website [www.sotp.org](http://www.sotp.org) or contact Jill Gillming at [LittleLambs@sotpmail.com](mailto:LittleLambs@sotpmail.com).

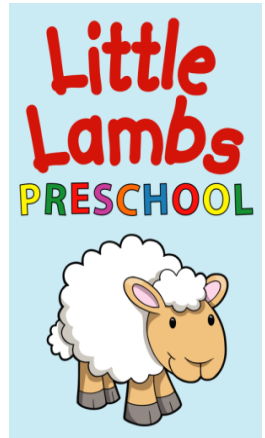

## STEWARDSHIP TALES



It happened one time after a pastor had made an appeal in church for a great and worthy cause, that a certain woman, a member of the church, came to him and handed him a check for \$50, asking at the same time if her gift was satisfactory. The pastor immediately replied, "If it represents you." There was a moment of soul searching thought and she asked to have the check returned to her. She left with it and a day or two later she returned handing the pastor a check for \$5,000 and again asking the same question, "Is my gift satisfactory?" The pastor gave her the same answer as before, "If it represents you." As before, a truth seemed to be driving deeply. After a few moments of hesitation she took back the check and left. Later in the week she came again with a check. This time it was for \$50,000. As she placed it the pastor's hand she said, "After earnest, prayerful thought, I have come to the conclusion that this gift does represent me and I am happy to give it."

## NEW MEMBER GATHERING

If you have been worshipping with us for a while here at SOTP and would like to know more about us as a worshipping community, we would love to have you join us at our New Member Gathering. We will be offering the gathering twice, once on Sunday April 24th from 3 – 5:30 pm and again on Wednesday April 27th from 6-8 pm. This will be an opportunity for you to learn more about the life and ministry of SOTP and for you to consider prayerfully whether or not you want to formally become a member of the SOTP family.

We will welcome new members on the following Sunday, May 1st. If you have any questions, please contact either Pastor Mark or Donna Kelly through the church office.



## LENTEN SOUP SUPPERS ~ THANK YOU!



Thank you to all of you who brought soup to our Wednesday Lenten Soup suppers. Thanks also to those who helped behind the scene! With everyone working together, we were able to serve about 150 people every Wednesday night.

—FFAA Committee (Fun For All Ages)

## SPRING BAZAAR WEEKEND ~ THANK YOU!

Thank you to all who helped!

- Those who helped set up & sell
- Those who made crafts
- Those who baked
- Those who purchased



All together over one weekend, we raised \$1,047.25 toward the new building! Thank you all SO much!

## THRIVENT INFORMATION

### **Thrivent Financial Members:**

Let Thrivent Donate Their Money to SOTP on Your Behalf

If you are currently a Thrivent member, please stop by the Thrivent table in the Crossroads between services **Sunday, April 17**. We will have one of our friendly Thrivent Financial representatives here to help you find out how to have Thrivent donate to SOTP on your behalf.

Thrivent donates money where their members request for it to go. *(Sometimes it seems like a huge hassle ~ let someone help you that does this for a living.)*

Last year alone, SOTP received \$6,444.00 in Choice Dollars with only some of our members that are Thrivent members participating. Just imagine if we all took advantage of this "free money"?

Also, find out how a service project of your choice could also earn up to \$250 from Thrivent.

**If you aren't currently a Thrivent member,** please feel free to stop by, introduce yourself and ask questions. They are here to help.



**THRIVENT  
FINANCIAL**



## DO YOU SHOP ON AMAZON.COM?

AmazonSmile is the same Amazon you already know. Same products, same prices, same service.

The only difference is Amazon will donate 0.5% of the price of your eligible AmazonSmile purchases to Shepherd of the Prairie.



Shop at AmazonSmile now and select: “Shepherd of the Prairie” as your non-profit organization.

## “FORWARD IN FAITH” WEBSITE



We have released a companion website which will cover our “Forward in Faith” Capital Stewardship Appeal. This site will focus on the Stewardship Appeal with content on background and vision, planning, architect renderings and tracking progress. In addition, we have a “Frequently Asked Questions” section as well as forms for your comments and suggestions.

## FOOD PANTRY

### Weekend of April 2 & 3 Is Food Pantry Collection Weekend at SOTP



#### NEEDS THIS MONTH:

Dressings	Kitchen Basics (flour, sugar...)
Crackers	Cookies
Shampoo	Deodorant

AND AS ALWAYS, CHECKS MADE OUT TO SOTP THAT STATE “FOOD PANTRY” IN THE MEMO WILL BE FORWARDED TO THE FOOD PANTRY.

*The Mission of Grafton Food Pantry: “... to strive to improve the lives of our friends and neighbors in need by providing food items and education on nutrition and smart shopping. We treat every individual with respect, privacy and dignity on their journey to becoming independent of our services. We are committed to educate and bring our community together in the fight to end hunger.”*

SOTP is committed to the Grafton Food Pantry. Thank you for your support.

## STUBBS FAMILY

Shepherd of the Prairie Lutheran Church proudly sponsors the Stubbs family, missionaries in Tanzania. If you haven't looked at their website, please take a moment and see what amazing things SOTP is part of in another part of the world.

[www.StubbsMission.info](http://www.StubbsMission.info)

### WELCOME TO THE STUBBS' FAMILY WEBSITE

Current News updated 23 July

Home Assignment 2015 Updated 22 July

FAQ

Support/Projects Updated 22 July

Kids (now ancient)

Favorite Links

Calendar

BLOG updated 1 Feb

2014-15

2013-14

2012-13

2011-12

2010-11



Marissa Megan Juliana Randy Carol Nathan



Photo galleries 2012-2014

Photo galleries 2006-2011

We have now completed our ninth year serving as missionaries with the ELCA (Evangelical Lutheran Church in America) doing leadership development, capacity building, and evangelism through the music department at Tumaini University Makumira in Tanzania, East Africa.

## ALTAR FLOWERS

- \$25 donation marked "flowers"
- Take flowers home after 2nd service or give them to a shut in



## COFFEE HOUR

- Drop off treats
- Help in the kitchen
- Or both



There are still many slots for altar flowers &/or coffee hour available. Such a great way to celebrate an anniversary, birthday or anything else... It's also a wonderful way to remember a loved one.

**Sign up sheets are on the "Mission Control" board in the Crossroads.**

## 2016 LENTEN & EASTER OFFERINGS

**Lenten Offerings** are divided between the following charities:

- \* **Feed My Starving Children:**  
Volunteers (like our SOTP youth) pack fortified meals which are sent to 70 countries around the world to feed malnourished children.
- \* **Community Crisis Center:**  
Located in Elgin, this Center provides emergency shelter, no-cost counseling, food and other help for women and children in Kane County.
- \* **Senior Care Volunteer Network:**  
Formerly Faith in Action, they assist our senior neighbors in McHenry County and Sun City to live independently in their own homes. Some of the no-cost services provided are transportation, companionship, home and yard maintenance, and respite for caregivers.
- \* **Lutheran Social Services of Illinois:**  
LSSI is the largest statewide provider of social services to those in need in communities across the state. These include children's services, behavioral health services, family and prison ministry, senior services. Our contribution will go where it is most needed at this time.



**The Easter Offering** is given to Lutheran Social Services of Illinois:

LSSI, the largest statewide provider of social services, has found it necessary to drastically cut services to 4,700 people and eliminate 750 staff positions. This is because the state has not paid LSSI for services provided due to the state's inability to pass a budget.

## MARCH MUSIC REHEARSALS

- \* Prairie Ringers (Adult Bells): Tuesdays at 7:00 pm
- \* Adult Choir: Wednesdays at 7:15 pm

### Children's Choir & Bell Rehearsals ~ Wednesdays

- 
- 4:30 - 5:00 pm, Jubilate Ringers (*grades 3-5*)
  - 4:30 - 5:00 pm, Praize Jamz Rehearsal (*see below*)
  - 4:30 - 5:00 pm, Treasures Choir (*grades 1&2*)
  - 5:00 - 5:30 pm, Joy Ringers (*grades 1&2*)
  - 5:00 - 5:30 pm, Cherub Choir (*2½-5 year olds*)
  - 5:15 - 6:00 pm Blessings Choir (*grades 3-5*)
  - 5:15 - 6:00 pm, Jubellation Ringers (*middle school*)

- \* Praize Jamz, Sundays April 3 - 17, 2:00 - 3:00 pm
- \* Youth Band, Rehearsals April 3 & 10 at Noon, playing April 24th

## PRAIZE JAMZ WORSHIP SERVICE



Please join our youth **Saturday, April 23 at the 5:00 pm** worship service. This night promises to be an uplifting time of worship for all. Our youth have been rehearsing for weeks. We can't wait to share this night with you ~ so you can see how SOTP is raising up the next generation of worship leaders as we are instilling in them a love and passion to lead others into the presence of the Lord through song, as they lift their hearts and worship. We look forward to this special night with you.

## VACATION BIBLE SCHOOL ~ SAVE THE DATE!

CALLING ALL VBS VOLUNTEERS  
AND ATTENDEES!

Time to mark your calendar for VBS ~  
August 1 - 4, 2016.

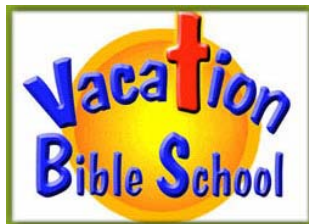

## **Don't Forget To Get Your PARENTING CHRISTIAN KIDS NEWSLETTER**

If you find it a struggle to raise strong Christian kids in a troubled world, then this newsletter is for you. Each Parenting Christian Kids Newsletter is packed with: Articles, parenting principles, pointers and more—all focused on a relevant, monthly theme. You'll find: Scripture woven throughout; Power Source—a prayer guide; Teachable Moment—a family activity tied to the theme and to Jesus; Current cultural trends and stats that provide insights for parents.



*The Parenting Christian Kids Newsletter is available online at [www.sotpyouth.com](http://www.sotpyouth.com)*

*We will also provide printed copies available in the Crossroads area at SOTP.*

**Chili's Give Back Program**

Bring this voucher when you visit (Dine In or To Go) the **Chili's** location identified below and 15% of your pre-tax purchase will benefit:

**SHEPHERD OF THE PRAIRIE LUTHERAN CHURCH**

---

Group/Charity

**3/28/16 – 4/10/16**

---

Event/Exp. Date  
One coupon per person, per visit at participating Chili's restaurants only. Cannot be combined with any other offer. Offer ends per expiration date above.

**ALGONQUIN, CRYSTAL LAKE, W. DUNDEE**

---

Chili's Locations

**#99999000006495**

Please support our mission trip, Creation Restoration 6.0.

Not only by going to Chili's March 28 through April 10.

But also sharing the 4 digit number with your friends and family (or share this page).

15% of your bill will come back to us to help fund CR6.0

## Trends

### *Increase in STDs*

Because of His deep love for us, God has given us the good gift of sex. Because of sin, our sexuality is broken. Consequently, we must endeavor to exercise this good gift in ways that bring glory to God and which fulfill his intent for sex.

Parents, we need to

earnestly teach our kids God's good design, along with helping them see the consequences that exist when we step beyond God's sexual borders and boundaries. Recently the CDC released new data on one of these consequences, the scourge of sexually transmitted diseases. The CDC is reporting that rates of chlamydia, gonorrhea, and syphilis have increased dramatically in recent years. Nearly twenty million new STD infections happen each year in the U.S., with the majority affecting 15 to 24 year olds. Parents, the culture is telling your kids that when it comes to sex, there are no borders and boundaries. Talk to your kids about God's order and design for sex and its place in heterosexual marriage.



## Latest Research

### *Religious Altruism and Empathy*

University of Chicago researchers have completed a study with some alarming findings. They have found that children of religious parents may not be as altruistic as their parents might think.

The report says that children of religious parents may be

less empathetic and sensitive than other kids. The researchers believe their finding undoes the conventional belief that religion plays an essential role in childhood moral development. But is this the case? Perhaps the problem is not with religion, or Christianity specifically, but with the type of Christianity we've chosen to embrace, model, and teach. Could it be that our North American affluence has facilitated a type of Christianity Tom Sine once called "the American dream with a little Jesus overlay?" Jesus talked more about the dangers of money and wealth than he did about heaven and hell combined. We must live and teach a James 1:27 faith, that pure and undefiled religion is one that cares for the afflicted

35% of college students say that they've consumed five or more alcoholic drinks in a row during the prior two week period.

*(Monitoring the Future survey from the University of Michigan's Institute for Social Research)*

## QUICK STATS

### FROM THE WORD...

The book of Proverbs – a book of wisdom – reminds parents in Proverbs 22:6 of their responsibility to teach and train their children in ways that reorient children and teens away from a lifestyle of selfishness and towards a wise and prudent way of life that steers clear of danger (v. 22:5). Proverbs 22:6 offers multiple levels of wise and good advice to parents. First, parents are the ones who are to provide training. In our current culture, this means that we don't leave the moral education of our kids up to the media, peer group, or prevailing spirit of the times. As parents, God has given us both authority and a duty to take charge. Second, we must recognize and respect our kids' God-given gifts and abilities. In other words, "the way he should go" takes into account their God-given uniqueness. We must help them discover and use their distinct gifts and abilities. Finally, the effort we put into obediently following God's command to train our kids will result in our kids growing up with the opportunity to choose to live by the course we've charted for them as we've encouraged them to choose God's wise way rather than their own foolish path. While it's not a hard-and-fast promise, it is a general statement of how things will most likely turn out. Are you parenting your kids with wisdom?

***“Train up a child in the way he should go; even when he is old he will not depart from it.” Proverbs 22:6***

### OUR YOUNGEST MEMBERS NEED YOU

We need more volunteers to serve in the nursery during worship services once a month (or try it one time & see how you like it).

The nursery provides a safe, fun environment for children under four. We would appreciate your help in caring for the youngest members of our SOTP family! Contact Jen Powe 847/331-1423 or [jen330@gmail.com](mailto:jen330@gmail.com) for more information.



Nursery

## APRIL VOLUNTEER SCHEDULES

		April 2 & 3	April 9 & 10	April 16 & 17	April 23 & 24	April 30
Presiding Minister		Pastor Mark Boster				
Altar Guild	5:00 SAT	Becky Tuzik, Tom & Darlene Polzin				
	9:00 AM	Donna Newbanks & Judie Symbal				
	10:45 AM	Sandy Hupert & Merrily Burkland	Barb Beaudette & Marlene Boehler	Pam & Darren Walloch	Jan & Don Koerner	
Altar Flowers	Week- end	Lynn Broderdorf & family, in memory of Lenny Johnson	Dick & Janet Larrison, celebrating their 57th anniversary		Don & Jan Koerner, celebrating their 52nd anniversary	
Bulletin Assem- blers	WEEK- END	June Kobler & Annette Carlson	Marian Mesenbrink & Marlene Tresp	Gordon & Jan Burseth & Deanna Moore	Elaine Neukirch & Barb Krmpotich	
Coffee Hour Hosts	SUN	<i>&lt; Help needed, please sign up in the Crossroads &gt;</i>				
Coffee Hour Treats	SUN	Wayne & Audrey Schmidt, celebrating Wayne's 75th Birthday	<i>&lt; Help needed, please sign up in the Crossroads &gt;</i>			
Commun- ion Bread	5:00 SAT	Tom Noesen and Bev Pinelle				
	SUN	Brandi Lorenzo	Jen Kolcz	JoAnn Ward	Lanita Palermo	
Greeters	5:00 SAT	Stevie Massei	Nancy Zunker	Elizabeth Anderson	Stevie Massei	Betty Knawa
	9:00 AM	Terry Halpin & Elaine Brody	Terry Halpin & Sara Solem	Terry Halpin & Judy Sanford	Terry Halpin & Donna & Harry Reynolds	
	10:45 AM	Vic & Kathy Pizzaro	Bob & Carolyn Malm			



## APRIL VOLUNTEER SCHEDULES *(cont)*

		April 2 & 3	April 9 & 10	April 16 & 17	April 23 & 24	April 30
Nursery	9:00 AM	Jen Powe	Judie Symbal	Jen Powe	Jen Powe	
	10:45 AM	Mary Lee Rishel	Blue Geller	Jocelyn Doden	Sandy Hupert	
	Clean Up	Mary Lee Rishel	Blue Geller	Jen Powe	Sandy Hupert	
Sound-board	5:00 SAT	Dan Willis	Dan Willis	Dick Brush	Dick Brush	
	9:00 AM	Jim Rice	Tom Polzin	Jim Rice	Tom Polzin	
	10:45 AM	Brian Ott	Tim Torkelson	Brian Ott	Tim Torkelson	
Ushers	5:00 SAT	Denis & Carol Minutillo	Ron Mudge & Becky Tuzik	Dan & Cheryl Mandro	Becky Tuzik Doreen Drinan	Don & Barb Hoppensteadt
	9:00 AM	WAYNE SCHMIDT, Jerry & Marty Bergman, Warren Brody, John Jensen, Walter Lemke	JACK CONTI, James Blanchard, Chris Hinde, Merlyn & Harriet Thompson, Marlene Tresp	ROY RANKIN, John Ameson, Chris Solem, Walter & Carol Roth, Darrel Thompson, Dan Wentzloff, Carol Engstrom	SID SORENSEN, Mike & Michelle Saletta, Jeff & Karen Stipes, Ed & Carolyn Cuttle	
	10:45 AM	BOB MCDUFFEE, John Richardson, Paul Ross, Michelle Saletta, Chris Swanson	MARK FRENDRIS Patrick Fleener, Charlie Powe, Andrew Szekely	JOHN BOEHLER Don Koerner, Adam Walloch & Darren Walloch	BOB MCDUFFEE Vik Bekeris, Dick Gerhardt, John Richardson	
Visual	9:00 AM	Ferdie Kimminau	Tim Reincke	Ferdie Kimminau	Tim Reincke	
	10:45 AM	Jack Ott	Alan Torkelson	Jack Ott	Alan Torkelson	

**If you aren't currently involved in ministry at Shepherd of the Prairie and would like to find your niche, please contact the church office at 847/669-9448. There are so many different ways to get involved, let us help you.**

## FINANCIAL NEWS

### Treasurer's Report

Operating Budget Year-to-Date as of February 29, 2016:

	YTD Actual	YTD Budget
General Fund Income:	\$ 101,344.53	\$ 95,758.00
General Fund Expenses:	\$ 88,997.73	\$ 95,764.00
Net Income:	\$ 12,346.80	\$ (6.00)

**General Fund Notes:** Through February operating income was more than expenses by \$12,346.80. Member contributions are over budget by \$6,519.85. Expenses are under budget \$6,766.27. Overall General Fund Income is more than Expenses to Budget YTD \$12,352.80 primarily due to unfunded Provision Accounts, controlled staff costs and increased member contributions. We continue to encourage the restraint of staff and mission teams in their spending in the various expense categories.

### Building Fund Year-to-Date as of February 29, 2016:

Building Fund Begin Balance 02/01/2016:	\$ 192,880.21
Debt Reduction Donations	\$ 785.00
Building Fund Donations	\$ 0.00
Forward in Faith	\$ 133,297.43
Mission Plus Interest Income	\$ 273.79
Memorial Donations Building Fund	\$ 0.00
<b>Building Fund Income/Donations:</b>	<b>\$ 134,356.22</b>

Loan Principal Payments	\$ 8,301.64
Loan Interest Payments	\$ 2,704.36
Principal Only Payments	\$ 405.00
Capital Campaign Expenses	\$ 0.00
Architectural Expenses	\$ 0.00
<b>Building Fund Total Expenses</b>	<b>\$ 11,411.00</b>
<b>Net Income(Loss):</b>	<b>\$ 122,945.22</b>
<b>Ending Fund Balance:</b>	<b>\$ 315,825.43</b>

We continue to accumulate funds in the Forward in Faith (Building Fund) account per Council direction and Congregation approval on future building expansion requirements.

The February month end building loan balance is \$522,502.10. Thank you for your faithful tithing as we continue to cover our mission operational costs, funding our building loan obligation, and our future building expansion.

Jim Henley  
SOTP Treasurer

## APRIL BIRTHDAYS

- 1 Jacob Riebock
- 2 Mary Tabatt
- 3 Dave Frederickson, Kristen Bala,  
Robin Anderson
- 4 Amy Casablanca
- 5 Darlene Soest, Mary Lee Rishel
- 6 Dorothy Carlborg, Janet Suski,  
Jessica Dawson
- 7 Larry Scimeca, Dotty Lucia, Lynn Moran
- 8 Lindsay Debolt, Lindsay Sparks
- 9 Mitchell Flanagan, Roger Clausen,  
Edward Cuttle, Cole Raines,  
Addison Raistrick
- 10 Donald Kundich, Debbie Lindquist,  
Kerry Miller, Paige Cordle,  
Camden Dean
- 12 Frank Cesario, Eloise Torkelson,  
Andrew Ressler, Colton Allegretti
- 13 Jack Conti, Suzanne Alpert,  
Delainey Black
- 14 Marc Piskule, Kevin Miller,  
Catherine Johnson, Cecilia Ramey
- 15 Joan Kimminau, Kim Frendreis,  
Kathleen Bloomfield, Wylder Weston,  
Janna Trevino
- 16 Ernest Hermes, Roberta Seroni,  
Linda Dungey, Jill Behm,  
Jennifer Huston, Brooke Mans, Lilly Lee
- 17 Kathy McGuine, Seth McCulloch
- 18 John Boehler, Letty Jocius,  
Marcie Schlachta, Alan Torkelson
- 19 Luke Palermo, Angela Crase
- 20 Troy Fleener, Zachary Ulmer
- 21 Jeffrey Cordle, Juliette Riebock
- 22 Dan Wentzloff, Dean Dobrolinsky,  
Allison McCann, Calle Mejdrich
- 23 Jeff Roberts, Kyle Frendreis,  
Matthew Kann
- 25 Carol Larson, Carol Didricksen,  
Kane Luedtke
- 26 Janice Burseth, Kelvin Walker,  
Rebecca Hennessey, Jill Lamb,  
Jamison Mathiesen
- 27 Andrew Brown
- 28 Walter Roth, Lynn Miller
- 29 Jenny Territo
- 30 Ken Lemke

## STAFF AND CONTACTS

### **Pastor Mark Boster**

847-515-2713 (Home)  
pastormark@sotpmail.com

### **Pastor Bill Waxenberg**

Director of Adult Education  
pastorbill@sotpmail.com

### **Greg Dowell**

Youth and Family Ministries Coordinator  
greg@sotpmail.com

### **Jane McMullen**

Director of Music & Worship  
jane@sotpmail.com

### **Dennis Lilla**

Technology Support Manager  
dennis@sotpmail.com

### **Donna Kelly**

Lay Ministry/New Member Coordinator  
donna@sotpmail.com

### **Michelle Rankin**

Office Manager  
michelle@sotpmail.com

### **Michael Waal**

Organist/Piano Accompanist  
michael@sotpmail.com

### **Jill Gillming**

Little Lambs Preschool

### **Annette Boster**

Cherub Choir

### **Michael Waal**

Blessings & Treasures Choirs

### **Denise James**

Joy Ringers

### **Michael Parmele**

Sunday School Director

### **Sue Wehnes, Renae Greene**

Contributions Secretaries

### **Congregation Council**

**Mike McCann**, *President*

**Matt Greene**, *Vice President*

**Amy Brittain**, *Secretary*

**Jim Henley**, *Treasurer*

**Adam Adams**

**Marlene Boehler**

**Cliff Dungey**

**Bud Hansen**

**Bob McDuffee**